



DENALI AT A GLANCE

This adventure is the perfect introduction to Denali National Park, a fixture on the Alaskan landscape. With bookending nights in Anchorage, spend two nights north of the park's entrance, the perfect vantage point for daily visits into Denali. Marvel at the spectacular landscape, the majestic wildlife, and the extraordinary views of the highest mountain in North America.

OUR PROMISE

While in our care you'll receive 24/7 support and the flawless delivery of your travel experience. We obsess over every detail so that you don't have to. Your journey is bespoke, created just for you. All that's left for you to do is to enjoy Alaska – it is wild, soulful and truly unforgettable.

ITINERARY AT A GLANCE

This 5-day/ 4-night trip is designed to showcase the dramatic landscapes and wildlife of Denali National Park. With a night in Anchorage at each end of the trip, the middle two nights are spent just north of the park's entrance—allowing for easy access into the park during the day. Trip highlights include the train journey to and from the park aboard the luxurious Alaska Railroad GoldStar dome train, and a flightseeing journey over Denali.

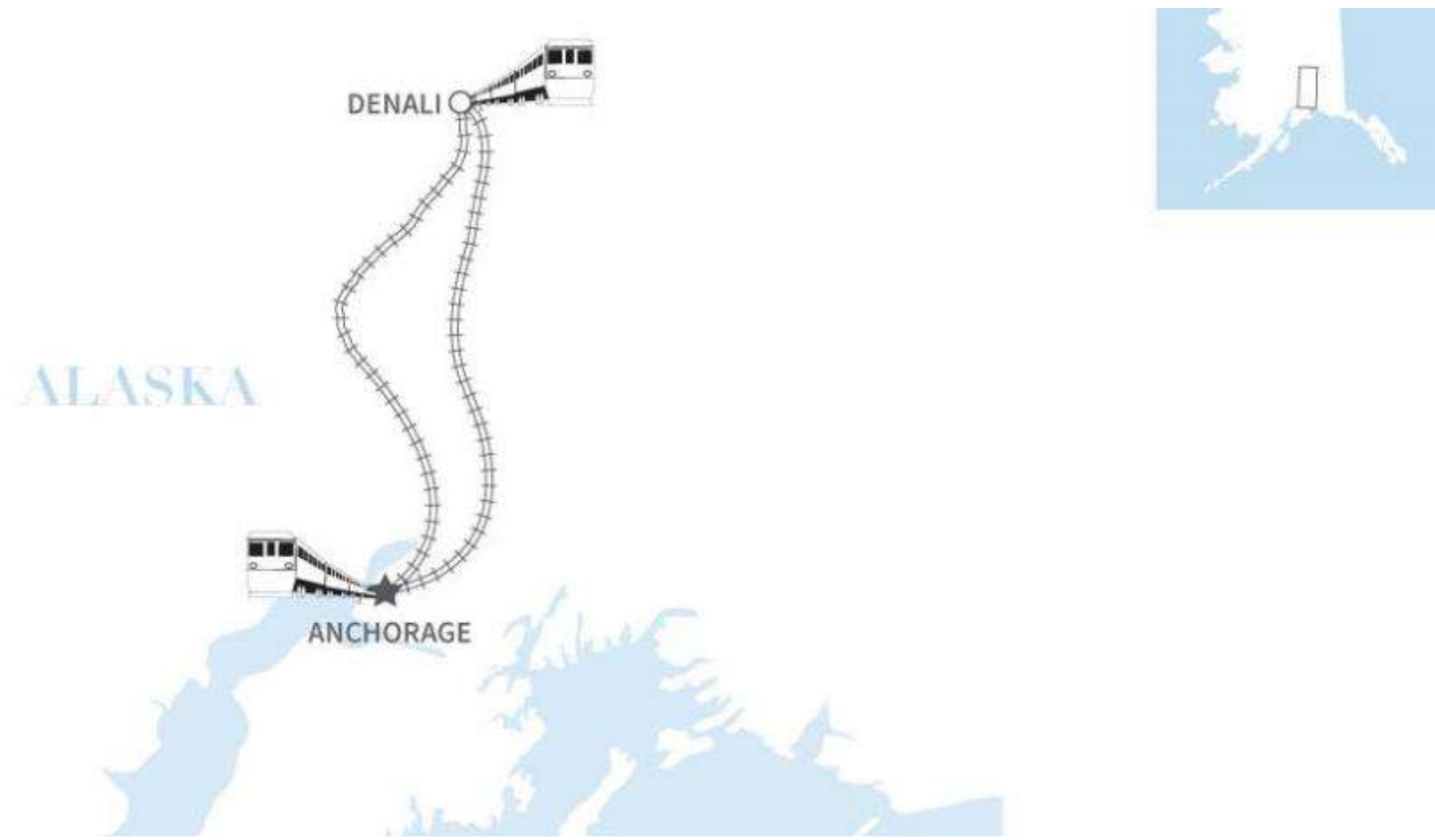

DAYS	
ONE	Arrive in Anchorage Afternoon at leisure Accommodations are at the Hotel Captain Cook
TWO	Board Alaska Railroad GoldStar dome train for day-long ride into Denali National Park Accommodations are at the Grande Denali Lodge
THREE	Travel into Denali National Park for wildlife spotting aboard Denali Backcountry Adventure Bus Return to park entrance in Alaskan bush plane Accommodations are at the Grande Denali Lodge
FOUR	Return to Anchorage via Alaskan Railroad GoldStar dome train Accommodations are at the Hotel Captain Cook
FIVE	Private transfer from your hotel to Anchorage International Airport End of journey



DAY ONE

Arrive in Anchorage

After picking you up at the airport in Anchorage, your driver will transport you to your hotel and you are free to begin exploring the city. This evening you will have the opportunity to enjoy dinner on your own, at one of our recommended restaurants. Accommodations are at the Hotel Captain Cook, in a Junior Suite

HIGHLIGHTS	n/a
MEALS	n/a
SERVICES	Private Sedan transfer
HOTEL	Hotel Captain Cook

DAY TWO

Travel by Rail to Denali National Park

After an early morning pick-up, you'll board the world-famous Alaska Railroad GoldStar dome train for the scenic, full-day ride to Denali National Park. From the open-air platform or glass-covered observation deck, you'll soak up views of tundra, deep river canyons, and mountains—including magnificent Denali. Accommodations are at the Grande Denali Lodge, in a View Room.

HIGHLIGHTS	Scenic journey to Denali National Park via Alaskan Railroad's GoldStar dome train
MEALS	Breakfast & Lunch
SERVICES	Train transfer
HOTEL	Grande Denali Lodge



DAY THREE

Explore Denali National Park

Travel 95 miles into Denali National Park aboard the Denali Backcountry Adventure bus, spotting moose, bear, wolves and other wildlife along the way. After lunch, return to the park entrance in a classic Alaskan bush plane, flying through the awe-inspiring Alaska Range, over glaciers, and past the North Face of Denali. Accommodations are at the Grande Denali Lodge, in a View Room

HIGHLIGHTS	Exploring Denali National Park, spotting wildlife and enjoying a return trip via Alaskan bush plane
MEALS	n/a
SERVICES	Full-Day Guide Flight transfer
HOTEL	Grande Denali Lodge

DAY FOUR

Travel from Denali to Anchorage

Return to Anchorage on the Alaska Railroad GoldStar dome train, passing over Broad Pass, Hurricane Gulch, and one of the most spectacular views of Denali. Accommodations are at the Hotel Captain Cook, in a Junior Suite

HIGHLIGHTS	Scenic return journey from Denali National Park to Anchorage via Alaskan Railroad’s GoldStar dome train
MEALS	Lunch & Dinner
SERVICES	Train transfer
HOTEL	Hotel Captain Cook



DAY FIVE

Travel to Anchorage International Airport

Your driver will transport you from your hotel back to the Anchorage airport in time for your return flight. Safe travels!

HIGHLIGHTS	n/a
MEALS	n/a
SERVICES	Private Sedan transfer
HOTEL	n/a

ACCOMMODATION



North Face Lodge

Denali National Park, AK

Perched on the slopes of Sugarloaf Mountain, just outside the entrance to Denali National Park and Preserve, Grande Denali Lodge offers amazing views of the Nenana River Canyon, the Alaska Range, and surrounding wilderness. The 166-room hotel offers basic but comfortable accommodations in either private cabins or 300-square-foot rooms, most with mountain views. Enjoy fresh Alaskan fare, fine wines and breathtaking vistas while you dine at the lodge’s Alpenglow Restaurant.

Room View

Denali National Park

Room Size 300 sq. ft

Bed Type Two Queen beds

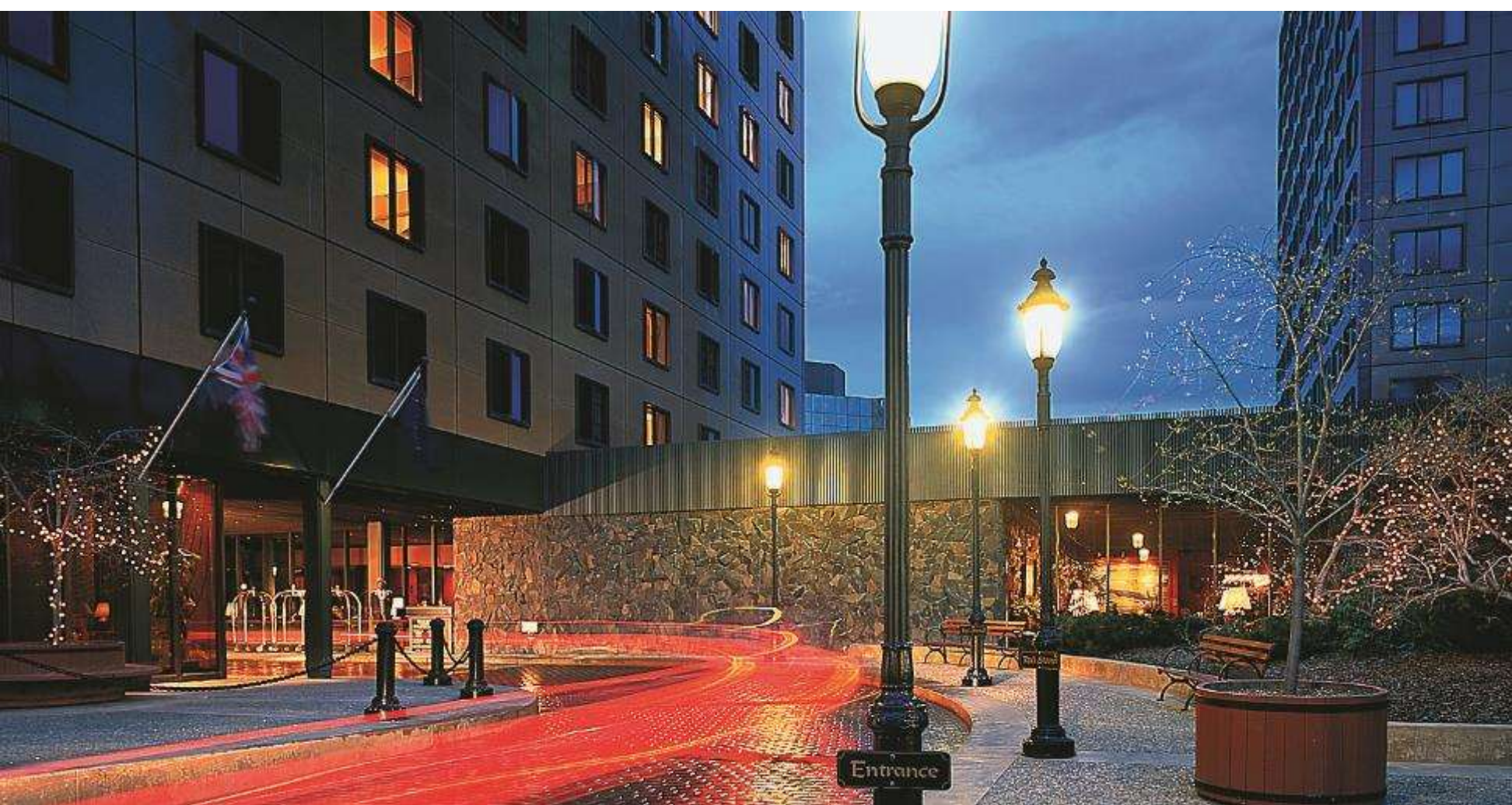

Hotel Captain Cook

Anchorage, AK

Arguably the only luxury hotel in Anchorage, and boasting downtown’s only four-diamond restaurant, the Captain Cook offers top service and accommodations for international travelers. Three restaurants, an athletic club and a full business center complement the 547 guest rooms. Perhaps the best features of the centrally-located hotel are its panoramic views of Cook Inlet, the Chugach Mountains, the Anchorage cityscape and Denali.

Room View

Bay or mountain

Bed Type One King bed

We Look Forward to Serving **You**



T: 604.408.1099 | **TF:** 888 999 6556 | **w:** entreedestinations.com

F: 604.736.2242 | **E:** alaska@entreedestinations.com

7th Floor, 134 Abbott Street, Vancouver, BC, V6B 2K4